

EverythingNice Stove Instructions!

Materials:

- Tin with a cover for Outer Tin
- Smaller tin (no cover needed) for Inner Tin
 - This tin must be 8mm to 10mm shorter than the Outer Tin
- Metric ruler
- Hole punch
- Marker
- Drill bits
 - 4 mm
 - 1.2cm – if not available up to 1.5cm will work

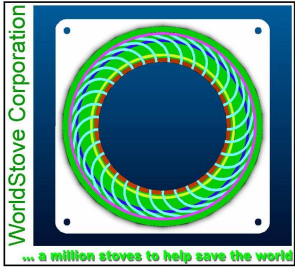

EverythingNice Stove Instructions!

Fabricating:

1. Place Inner Tin into Outer Tin. The diameter of the Inner Tin ($\emptyset_{Inner Tin}$) must be 8 to 10mm smaller than the Outer Tin ($\emptyset_{Inner Tin}$).
2. Measure from lip of Outer Tin to lip of Inner Tin. This distance should be *8mm to 10mm*.
3. Drill or punch as many $\emptyset 1.2$ to $1.5cm$ holes as can fit around the tin, as close to the bottom as possible. Record the diameter as $\emptyset_{Outer Hole}$.
4. Measure from the bottom of the Outer Tin to the top of the holes you just made. Record this dimension as distance '*d*'.
5. Measure from the bottom of the Inner Tin $d + 1/2 * \emptyset_{Outer Hole}$ and draw a line around the circumference.
6. Drill as many $\emptyset 4mm$ holes as possible centered on this line.
7. Measure down $d + 1/2 * \emptyset_{Outer Hole}$ from the top edge of the Inner Can and draw a line around the circumference. This will be the Fill Line for Fuel.
8. Measure the inner diameter of the Inner Tin. Record this as $\emptyset_{Inner Tin ID}$.
9. In the center of the Outer Tin lid, cut a hole of $1/2 * \emptyset_{Inner Tin ID}$.

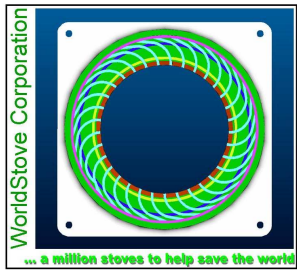

EverythingNice Stove Instructions!

Lighting:

1. Fill the Inner Tin with fuel (wood pellets, dry twigs, etc.) up to the line you have drawn below the top lip.
2. Place a fire starter (like wax, a few teaspoons of rubbing alcohol, etc.) on top of the fuel.
3. Place the Inner Tin inside the Outer Tin. Make sure the two sit concentrically.
4. Light the fire starter. After the fire is going, place the lid on the stove.

If made correctly, the flame should turn blue and there should be little smoke. This means a clean, complete burn of the fuel is taking place. The stove should leave behind char when the flame goes out.

(If you want to be sure the two tins are sitting concentrically, try drilling a hole through each at the center of the bottom. Then, put a small bolt through both holes, and lock them together with a lock washer and nut!)

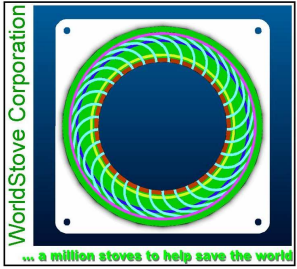

EverythingNice Stove Components!

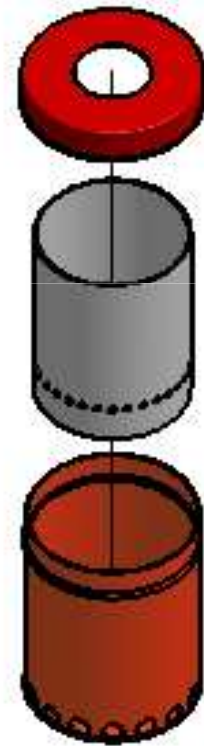
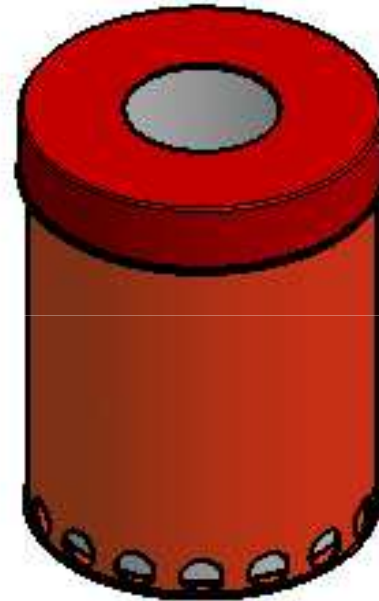
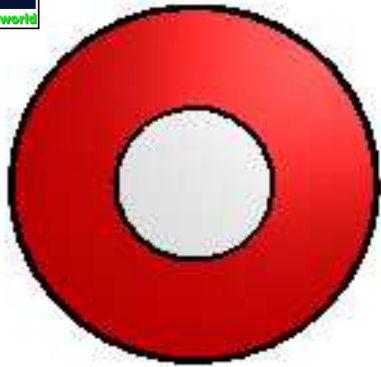

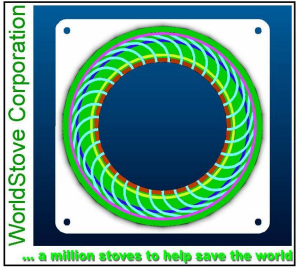

EverythingNice Stove Components!

